

GENERAL REQUIREMENTS

WORK PERFORMED SHALL CONFORM TO THE REQUIREMENTS OF THESE GENERAL NOTES, BUILDING CODE (1984 EDITION), AND ALL APPLICABLE LOCAL AND STATE CODES, ORDINANCES, RULES, AND REGULATIONS GOVERNING THE WORK TO BE PERFORMED.

ON SITE VERIFICATIONS OF ALL DIMENSIONS AND CONDITIONS SHALL BE THE RESPONSIBILITY OF THE CONTRACTOR. NOTED DIMENSIONS TAKE PRECEDENCE OVER SCALE. REPORT ALL DISCREPANCIES IN WRITING TO THE ENGINEER FOR CLARIFICATION.

NO DEVIATIONS FROM STRUCTURAL DETAILS ON ENGINEERED PLANS WITHOUT WRITTEN APPROVAL OF THE ENGINEER.

THE CONTRACT DRAWINGS AND SPECIFICATIONS REPRESENT THE FINISHED STRUCTURE. UNLESS OTHERWISE SHOWN, THEY DO NOT INDICATE THE METHOD OF CONSTRUCTION. THE BUILDER SHALL SUPERVISE AND DIRECT THE WORK AND HE SHALL BE SOLELY RESPONSIBLE FOR ALL CONSTRUCTION MEANS, METHODS, TECHNIQUES, SEQUENCES AND PROCEDURES. ANY OBSERVATION VISITS TO THE SITE BY ANY REPRESENTATIVE OF HALE & ASSOCIATES, INC. SHALL NOT RELIEVE THE BUILDER FROM HIS RESPONSIBILITY AND DO NOT GUARANTEE BUILDERS PERFORMANCE, AND SHALL NOT BE CONSTRUED AS SUPERVISION OF CONSTRUCTION.

CONTRACTOR SHALL PROVIDE OPENINGS AND SUPPORTS FOR MECHANICAL EQUIPMENT, DUCTS, PIPING, VENTS, ETC.

SITE WORK

ALL FOOTINGS SHALL REST ON FIRM, NATURAL SOIL OR APPROVED COMPACTED FILL. SOIL BEARING CAPACITY ASSUMED TO BE 1000 psf.

PROVIDE GROUND POISONING PER PHA MPS 815-3.6.

PROVIDE TERMITE AND DECAY PROTECTION PER PHA MPS SECTION 815.

CONCRETE

CONCRETE SHALL BE PLACED IN ACCORDANCE WITH CHAPTER 26 OF THE BUILDING CODE. IT IS TO BE MACHINE MIXED WITH A MAXIMUM OF 7 1/2 GALLONS OF WATER PER SACK OF CEMENT. CONCRETE TO REACH A STRENGTH OF 2000 PSI MINIMUM, IN 28 DAYS. (FIVE SACK MIX GRADE "B").

FOUNDATION AND FLOOR SLABS SHALL BE TREATED AS THOUGH THEY ARE TO BE CONSTRUCTED ON EXPANSIVE SOIL (UNLESS A SOILS REPORT IS SUBMITTED BY A QUALIFIED, LICENCED, CIVIL ENGINEER INDICATING A SOILS CONDITION OTHER THAN EXPANSIVE SOIL) AND SHALL CONFORM AS FOLLOWS:

(A) CONTINUOUS FOOTINGS SHALL BE PROVIDED UNDER EXTERIOR WALLS AND INTERIOR BEARING WALLS EXTENDING BELOW GRADE 24".

(B) REINFORCING STEEL SHALL CONSIST OF ONE CONTINUOUS NO. 4 BARS, ONE AT 3" FROM BOTTOM AND ONE AT 3" FROM TOP OF FOUNDATION.

(C) FLOOR SLAB SHALL BE A MINIMUM OF 4" THICK OVER 4" CLEAN AGGREGATE BASE AND REINFORCED WITH NO. 3 BARS AT 24" O/C BOTH WAYS OR 6 X 6 - 6/6 WELDED WIRE FABRIC.

(D) SATURATE THE SOIL 18" DEEP BEFORE PLACING THE CONCRETE SLAB.

MAINTAIN CONCRETE SLAB MINIMUM 6" ABOVE FINISH GRADE.

REINFORCING BARS SHALL BE DEFORMED BARS CONFORMING TO REQUIREMENTS OF U.B.C. STANDARD 26-7 ASTM 615-40. MINIMUM LAP FOR REINFORCING STEEL SHALL BE 40 BAR DIAMETERS OR 24-INCHES MINIMUM.

SILL BOLTS SHALL BE 1/2-INCH DIAMETER X 10" ANCHOR BOLTS AND SHALL BE EMBEDDED INTO FOOTING CONCRETE A MINIMUM OF 7". SPACING SHALL BE AS INDICATED ON DRAWINGS BUT NOT TO EXCEED 48".

APPROVED SHOT PINS MAY BE USED FOR INTERIOR, NONBEARING WALLS. SHOT PINS SHALL BE 3" LONG WITH CADMIUM WASHERS (RAMSBY #3348 - ICBO #1639 OR EQUAL).

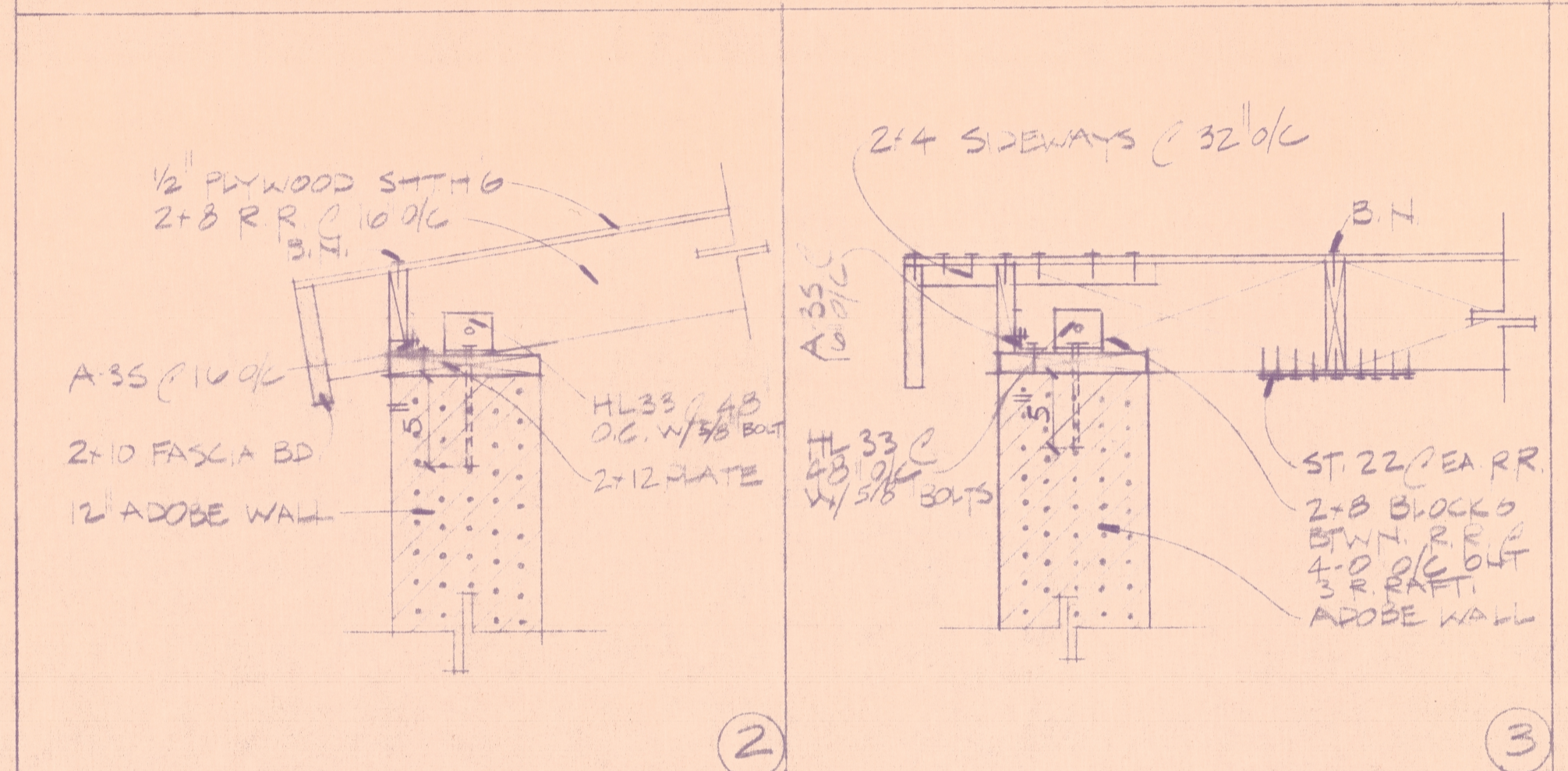

ROOF SHEATHING
 1/2" PLYWOOD CDX SHEATHING INDEX 32/16
 (EXT. BLUE) NAILING: USE 8d 1 1/2", 0", 2"
 NOTE: ROOF SPECS TO MATCH THAT OF ORIGINAL STRUCTURE, CONTRACTOR TO CONFIRM.

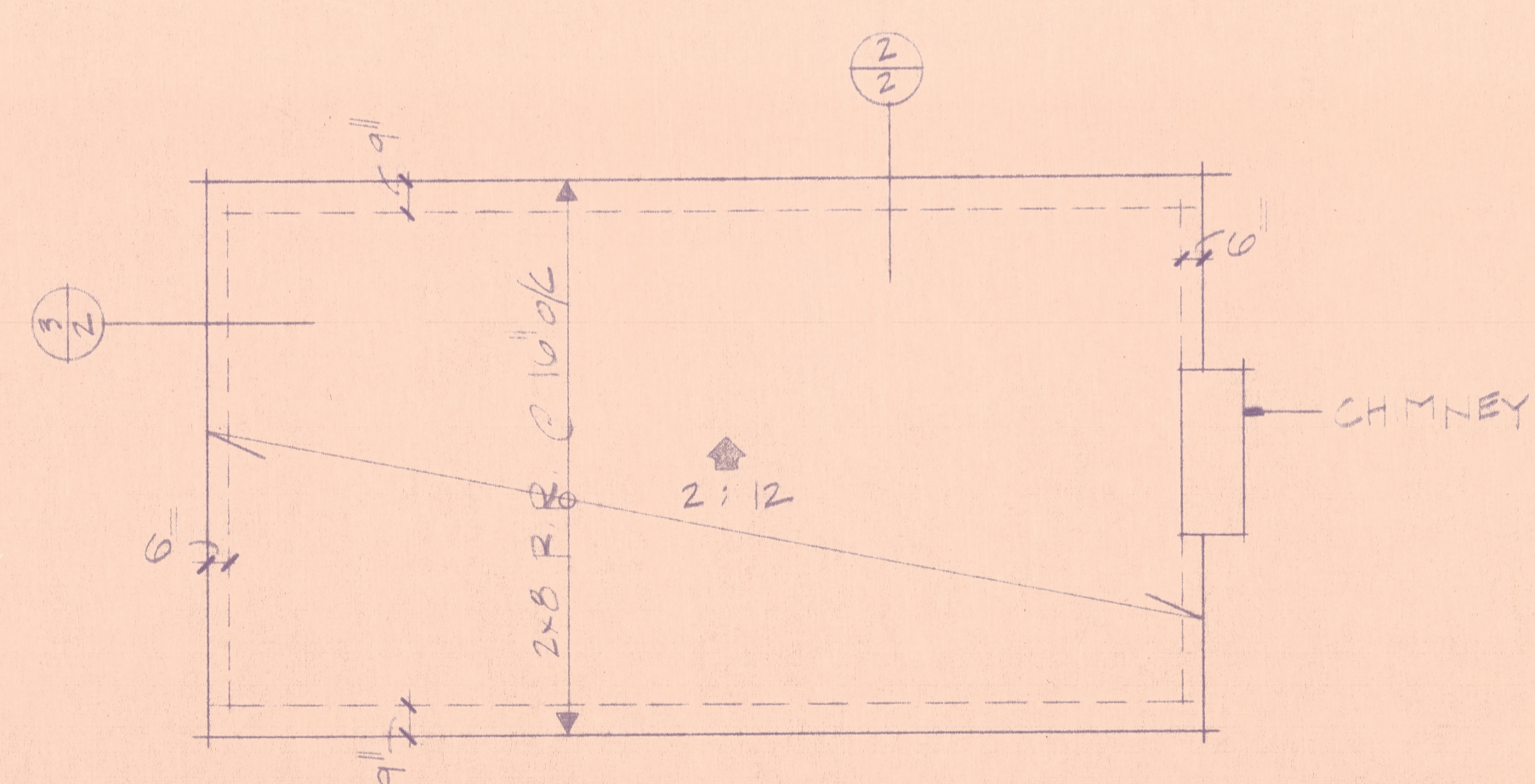

ROOF PLAN

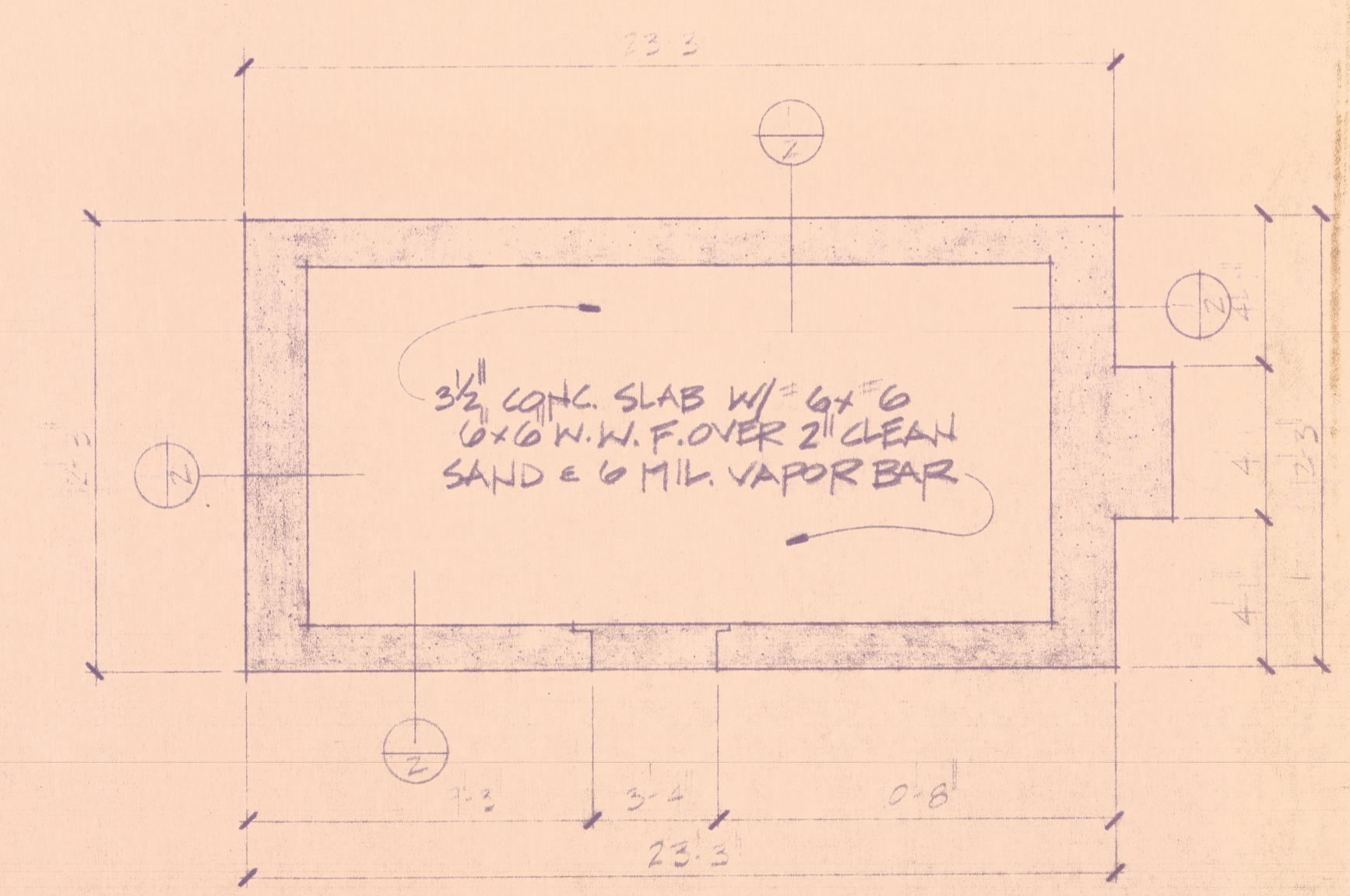
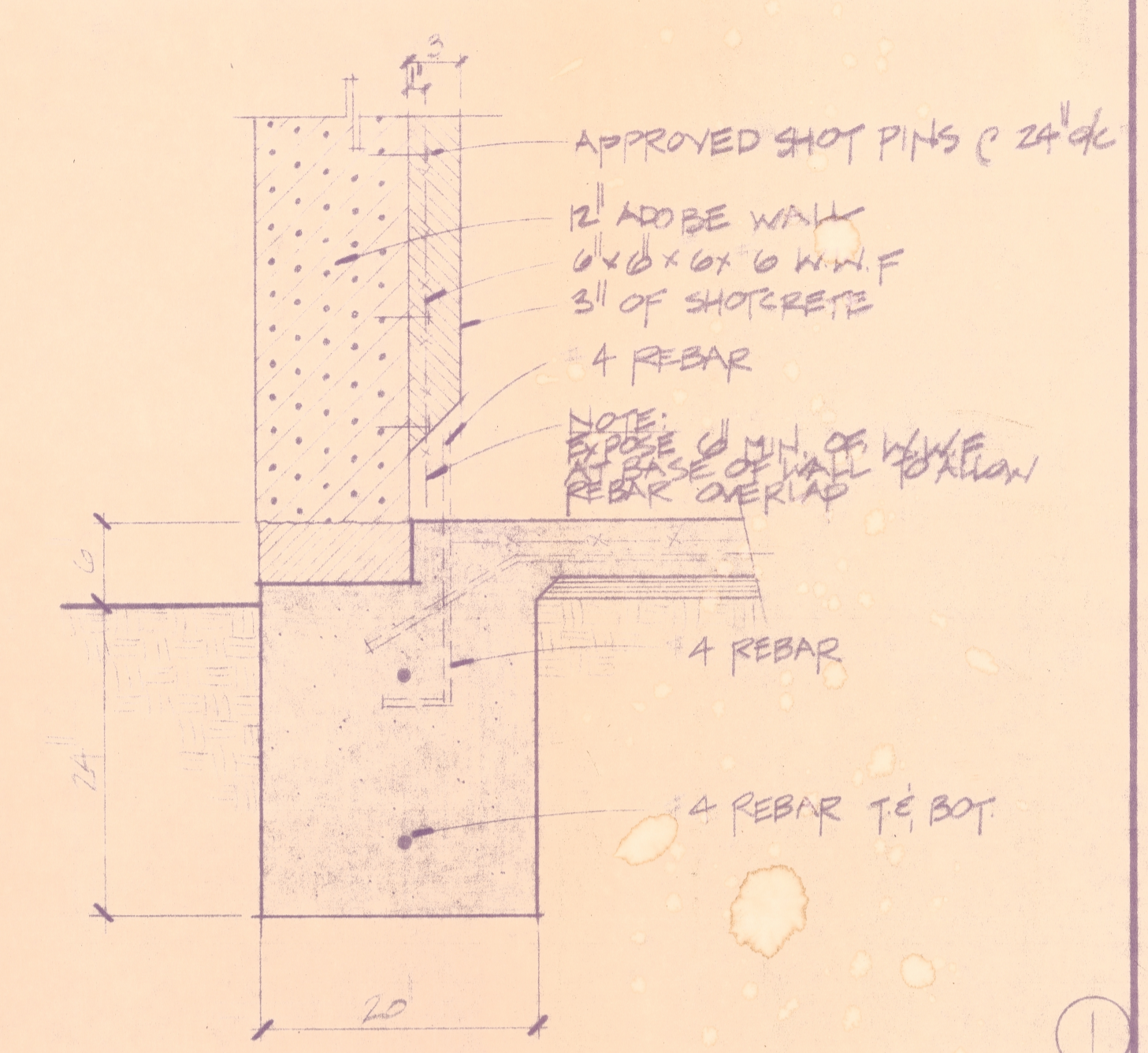

FOUNDATION PLAN

REVISIONS	BY

SANTA CARITA VALLEY 1.5" SUC 5.7V
 ADOBE BLDG. RELOCATION
 PROPOSED SITE

HALE & ASSOCIATES, INC.
CONSULTING ENGINEERS
 2404 SAN FERNANDO ROAD, NEWHALL, CALIF., 91321 (805) 259-9702

Date	OCT. 8/0
Scale	1/4" = 1'-0"
Drawn	K.S.H.
Job	8610088
Sheet	2
Of TWO	Sheets